

SECTION A-A  
SCALE 16:1

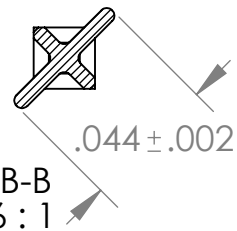

SECTION B-B  
SCALE 16:1

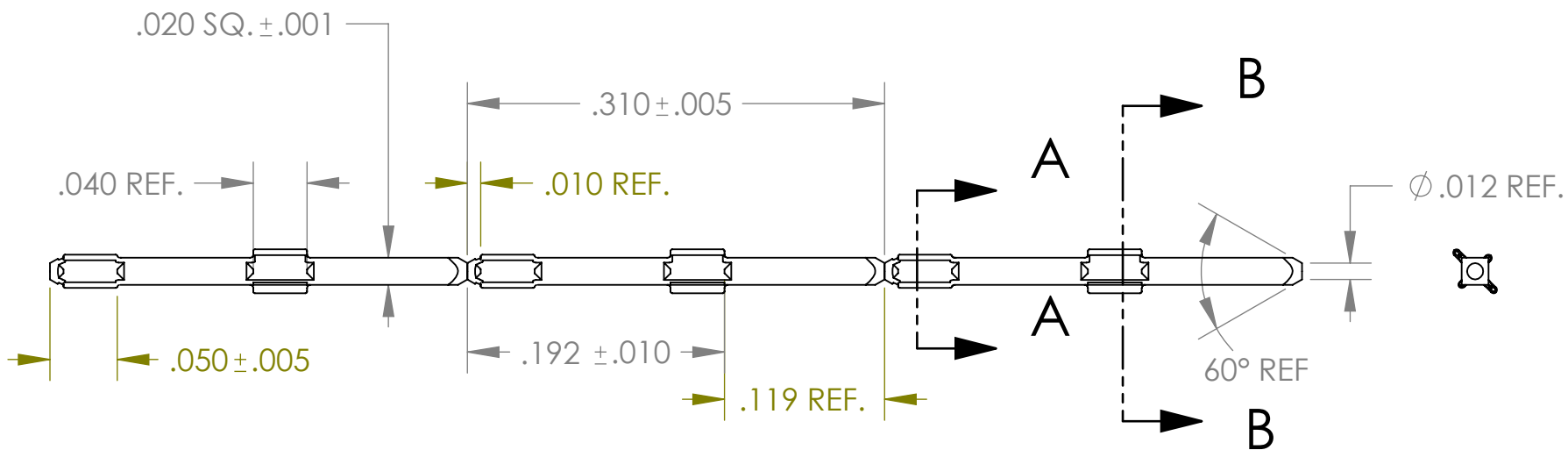

NOTES:

- 1) TANDEM PIN
- 2) PIN TIPS ARE PARABOLA REVOLVED
- 3) WIND .119 END FIRST ONTO REEL,  
END USER TO UNWIND STAR END FIRST
- 4) MEASURE EARS & STARS FROM TANGENT POINT
- 5) WIND 50,000 PER REEL

CONTROLLED DOCUMENT  
MANUFACTURING / FINISH PRINT

UNLESS OTHERWISE SPECIFIED:	NAME	DATE
DIMENSIONS ARE IN INCHES	B.B.	8/1/07
TOLERANCES:	UPDATED BY	8/3/10
FRACTIONAL ±	ENG APPR.	
ANGULAR: MACH ± BEND ±	MFG APPR.	
TWO PLACE DECIMAL ±	Q.A.	
THREE PLACE DECIMAL ±	COMMENTS:	
INTERPRET GEOMETRIC TOLERANCING PER:		
MATERIAL C197		
FINISH		
DO NOT SCALE DRAWING		

www.BeadElectronics.com		
TITLE:		
W020-511EAC		
SIZE	DWG. NO.	REV
A		
SCALE: 1:1	WEIGHT:	SHEET 1 OF 1



**PROPRIETARY AND CONFIDENTIAL**  
THE INFORMATION CONTAINED IN THIS DRAWING IS THE SOLE PROPERTY OF BEAD INDUSTRIES. ANY REPRODUCTION IN PART OR AS A WHOLE WITHOUT THE WRITTEN PERMISSION OF BEAD INDUSTRIES IS PROHIBITED.